



Everyday's **Solution**

WE SPEAK YOUR LANGUAGE...

Contents

Indicator

Lamp Series

Push Button

Control Box

Control Switch

Limit Switch

Micro Switch



**Indicator
Lamp** Series
Everyday's **Solution**

Indicator Lamp Series

In AD22-22- (LED) series of indicators is utilizing an LED shining chip as a light source. Thanks to the long life, low consumption, small volume, and lightweight, it is a product replaced the older kind of incandescent lamp and indicator neon lamp by new ones, enjoying brilliant features: high brightness, perfect reliability, unique design and innovatively manufactured. To fit in with top quality and aesthetic demand of users, we developed AD22-22D, double color lamp, position indicator, shining buzzer and mini short indicator, which proudly meet all the requirements of international standard lamp shape, made of polycarbonate with high intensity, enjoying better anti-surge performance, and bolt-type connector designed has already made it safer, convenient and easy to use. The signal lamp series are suitable to the electrical appliance circuit of AC voltage up to 380V, 50Hz or 60Hz, DC voltage below 380V, used as kinds of indication signal, warning signal, accident signal, and other signals.

SL22-22DS

Colors : 
LED Indicator



Voltage :
21-DC.AC6V
22-DC.AC12V
23-DC.AC24V
24-DC.AC36V
25-DC.AC48V
26-DC.AC110V
27-DC.AC127V
31-AC220V
32-AC380V

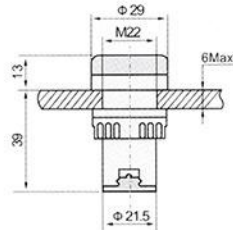

SL22-22D

Colors : 
LED Indicator



Voltage :
28-DC220V

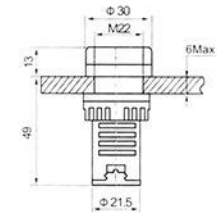

SL22-16DS

Colors : 
LED Indicator



Voltage :
12V AC/DC
24V AC/DC
36V AC/DC
48V AC/DC
110V AC/DC
127V AC/DC
220V AC/DC
380V AC/DC

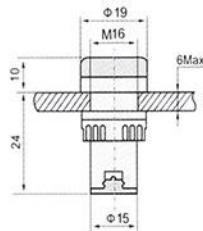

SL22-22MSB
Flash Buzzer

Color : 
LED Indicator



Voltage :
21-DC.AC6V
22-DC.AC12V
23-DC.AC24V
24-DC.AC36V
25-DC.AC48V
26-DC.AC110V
27-DC.AC127V
31-AC220V
32-AC380V

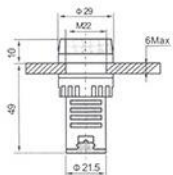

Voltage
Indicator

Color : 
LED Indicator



Specification:
Input : (50-500V)

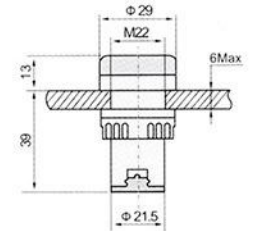

Amper
Indicator

Color : 
LED Indicator



Specification :
Input : 230-240VAC
CT : (0-100A)

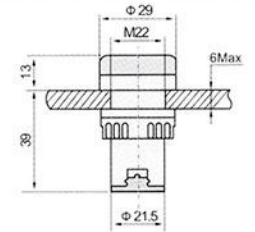

Multi
Indicator

Color : 
LED Indicator



Specification :
Input : (50-500V)
CT : (0-100A)

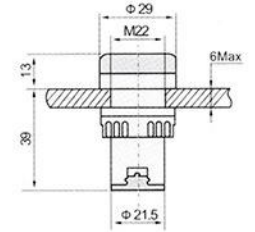

Temperature
Indicator

Color : 
LED Indicator



Specification :
Input : 230-240VAC
Temp : (0-110°C)

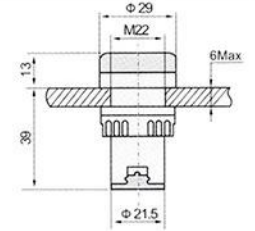

Frequency
Indicator

Color : 
LED Indicator



Specification :
Input : 230-240VAC
Freq : (20-100HZ)

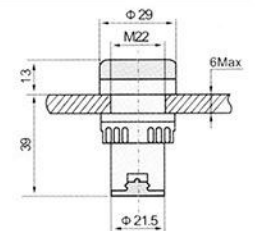

Push Button Series

The push-button series are used in controlling circuit of AC50Hz or 60Hz, the voltage to 660V, DC voltage below 400V, it is used for controlling signal and interlocking. The main body adopts zinc alloy and high-grade anti-flaming plastic, the contact adopts special silver alloy, so it enjoys high anti-electrical erosion property. Our products comply with GB/T 14048.1 and IEC 1-5-60947, all products have gained CE, ROHS and UL certification.

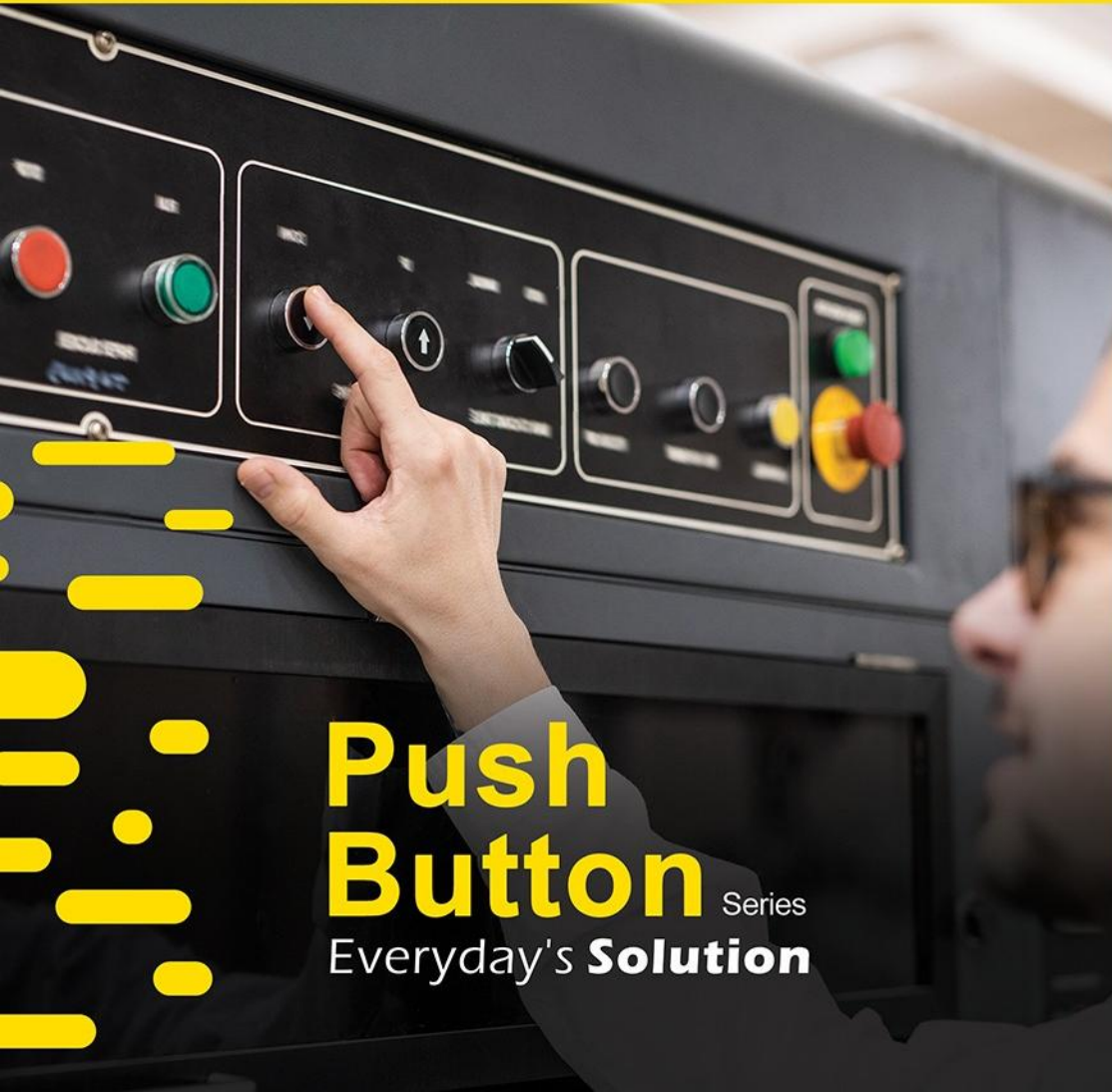

Push Button Series
Everyday's **Solution**

XB2-BA31

Color : 
Contact : N/O



Circuit :

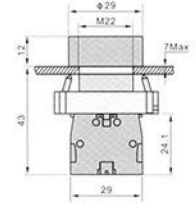

XB2-BA42

Color : 
Contact : N/C



Circuit :

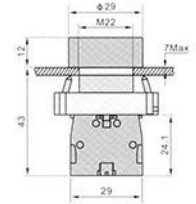

XB2-BA3341

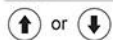
Color : 
Contact : N/O



Circuit :

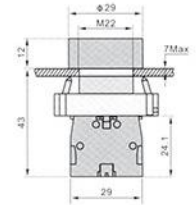

XB2-BA3351

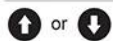
Color : 
Contact : N/O



Circuit :

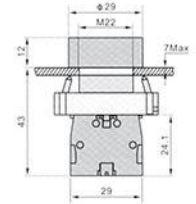

XB2-BA5331

Color : 
Contact : N/O



Circuit :

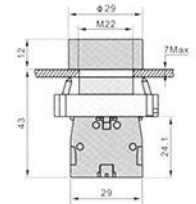
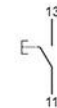

XB2-BA4342

Color :  
Contact : N/C



Circuit :

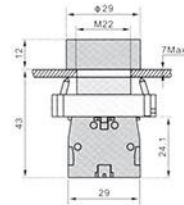
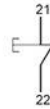

XB2-BA3311

Color :  
Contact : N/O



Circuit :

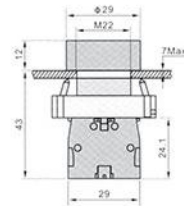

XB2-BA3361

Color :  
Contact : N/O



Circuit :

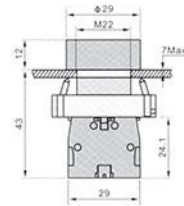

AD22-BW3361

Colors : 
Contact : N/O
LED Neon



Voltage :

- 21-DC AC6V
- 22-DC AC12V
- 23-DC AC24V
- 24-DC AC36V
- 25-DC AC48V
- 26-DC AC110V
- 27-DC AC127V
- 31-AC220V
- 32-AC380V

Circuit :

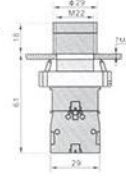
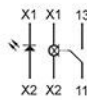

AD22-BW3462

Colors : 
Contact : N/C
LED Neon



Voltage :

- 21-DC AC6V
- 22-DC AC12V
- 23-DC AC24V
- 24-DC AC36V
- 25-DC AC48V
- 26-DC AC110V
- 27-DC AC127V
- 31-AC220V
- 32-AC380V

Circuit :

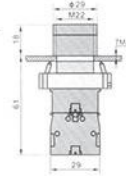

SB7-EH31

Color : 
Contact : N/O



Circuit :

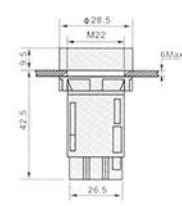

SB7-EA42

Color : 
Contact : N/C



Circuit :

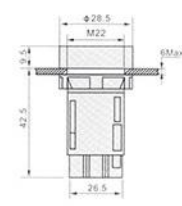

SB7-SW3361

Color :    
Contact : N/O
LED



Circuit :



6V~380V AC/DC
50~60 HZ

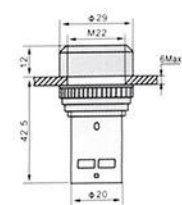

SB7-SW3462

Color : 
Contact : N/C
LED



Circuit :



6V~380V AC/DC
50~60 HZ

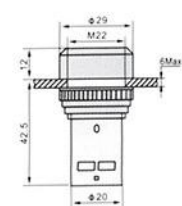

Basic Technical Parameters of Button

Rated Insulation Voltage	AC600V(50Hz/60Hz)	
Conventional Heating Current	10A	
Insulation Resistance	≥ 50M Ω	
Contact Resistance	≤ 25Min Ω	
Mechanical Life	100x10 ⁴ (Push Button)	50x10 ⁴ Selector Switch Key Switches
Electrical Life	500x10 ⁴ (Push Button)	25x10 ⁴ Selector Switch Key Switches

Basic Technical Parameters of Signal Lamp

Insulation Resistance	≥50M Ω
Contact Resistance	≤25Min Ω
Pf With Stand Voltage	Ac2.5KV/min
Voltage Wave	± 20%
Brightness	60cd/m ²
Continuous Working Life	10x10 ⁴ h

The innovation of our employees

We regard innovation as an important basis if we are to meet the ever-changing market requirements. We create this basis by giving our employees the freedom to act upon their own initiative within the existing, flat hierarchical structure of the company. In this way, we can operate in a more targeted and individual manner in order to fulfill your wishes and requirements.

XB2-BD21
2 position stay put
Contact : N/O



Circuit :

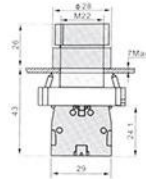

XB2-BD45
2 position
1 spring return
from right to left
Contact : N/O

XB2-BD33
3 position stay put
Contact : N/O + N/O



Circuit :

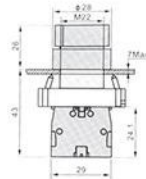
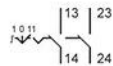

XB2-BD53
3 position
2 spring return
to Center
Contact : N/O + N/O

XB2-BG21
2 position with
key stay put



Contact : N/O



Circuit :

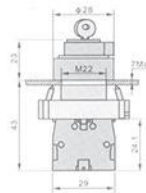

XB2-BG33
3 position with
key stay put



Contact : N/O + N/O



Circuit :

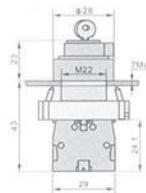
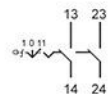

The innovation of our processes

Process optimization ultimately delivers the greatest benefits for you. But putting new innovations into practice, we are able to improve and automate manufacturing and production methods. Process optimization enables us to reduce manufacturing costs without compromising on the quality of products. In this way, we can guarantee you lower costs and faster processing.

LAY5-BK2465
2 position stay put
Direct Supply

Color :



Contact : N/O or N/C

LED



Circuit :

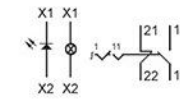

220/240V BA9s bulb

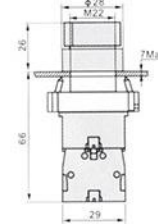

LAY5-BK3465
3 position stay put
Direct Supply

Color :



Contact : N/O + N/O
or
N/C + N/C

LED



Circuit :

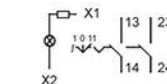

220/240V BA9s bulb

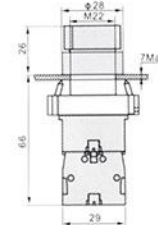

XB2-BL8425
Without pilot light

Contact : N/O + N/C



Circuit :

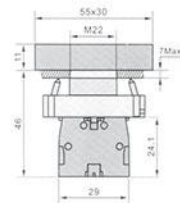
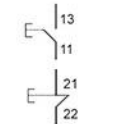

XB2-BW8465
Without pilot light

Contact : N/O + N/C

LED



Circuit :

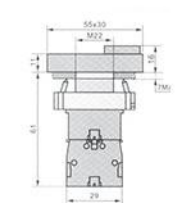
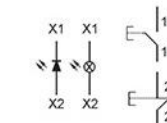

The innovation of our products

We break new ground. Practically today when market requirements are changing at an ever more rapid pace, we understand that our challenge is to meet these requirements. Product requirement represents both the basis and the result of our endeavors. This is manifested in numerous patents and unique selling points. We believe in our innovative strength. We also want to do justice to you.

XB2-BC42
Mushroom head

Color :



Contact : N/C



Circuit :

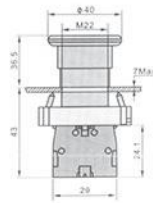
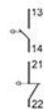

XB2-BS542
Turn to release

Color :



Contact : N/C



Circuit :

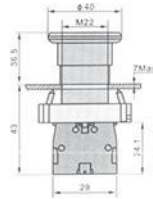

XB2-BS142
Key release

Color :



Contact : N/C



Circuit :

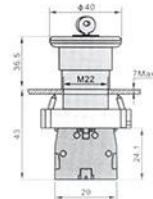

Emergency Button Series
Everyday's **Solution**

Miniature Push Button series

%100 innovation

- We are directly responsible for our work and have the necessary freedoms to be able to transform your requirements into specific solutions.
- With the help of new manufacturing methods and machines, we realize new ideas in order to offer you high-quality products.
- Process optimization improves the processing channels and enables us to act more quickly.
- In all areas, innovation forms the basis for meeting your requirements and for penetrating new markets. This is our challenge.
- Our employees create the basis for our innovations.

SDL16-22AD

Color :
 ● ● ● ● ●

LED



Circuit :

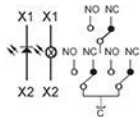

Contact : 2N/O + 2N/C

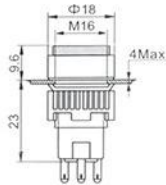

SDL16-22FD

Color :
 ● ● ● ● ●

LED



Circuit :

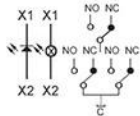

Contact : 2N/O + 2N/C

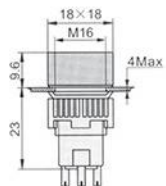

SDL16-22CFD

Color :
 ● ● ● ● ●

LED



Circuit :

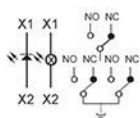

Contact : 2N/O + 2N/C

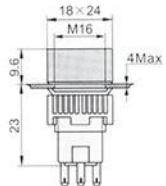

SDL16-22CFDFG

Color :
 ● ● ● ● ●

LED



Circuit :

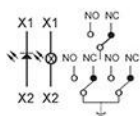

Contact : 2N/O + 2N/C

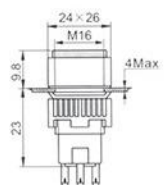

SDL16-22ZS
Mushroom Emergency
Auto Locking

Color :
 ●



Circuit :

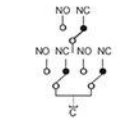

Contact : 2N/O + 2N/C

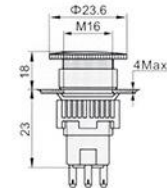

SDL16-11MD
Light Mushroom Emergency

Color :
 ● ● ● ● ●

LED



Circuit :

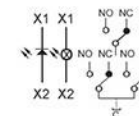

Contact : 2N/O + 2N/C

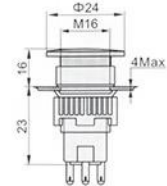

SDL16-11XA
90° 2 Position

Color :
 ●



Circuit :

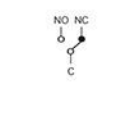

Contact : NO + NC

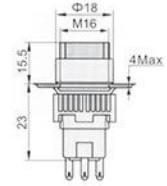

SDL16-11XF
90° 2 Position

Color :
 ●



Circuit :

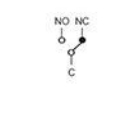

Contact : NO + NC

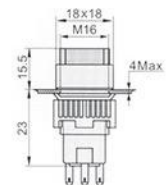

SDL16-11YA
90° 2 Position

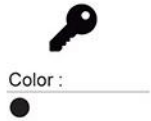

Circuit :



Contact : 2NO + 2NC

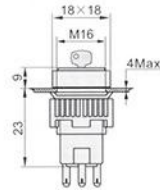

SDL16-11YF
90° 2 Position

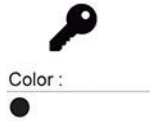

Circuit :



Contact : 2NO + 2NC

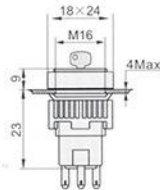

SDL16-11YCF
90° 2 Position



Circuit :



Contact : 2NO + 2NC

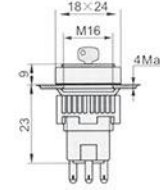

Size

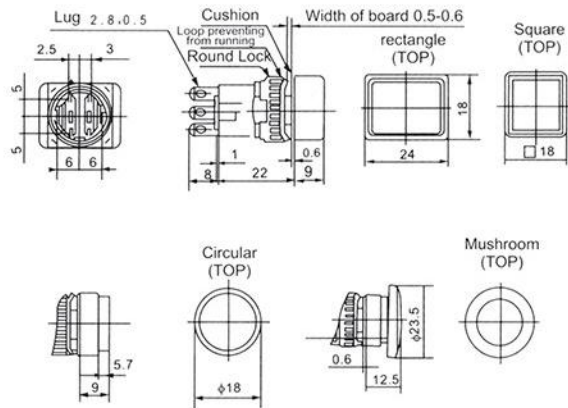

Joysticks Operator Push Button Series

The push-button series are used in controlling circuit of ACS0Hz or 60 Hz, the voltage to 660V, DC voltage below 400V; it is used for controlling signal and interlocking. The main body adopts zinc alloy and high-grade anti-flaming plastic, the contact adopts special silver alloy, so it enjoys high anti-electrical erosion property. Our products comply with GB/T 14048.1 and IEC1-5-60947, all products have gained CE, ROHS, and UL certification.

IS-BMR214
IS-BMR224

4 Position Stay Put
4 Position Spring Return



Contact

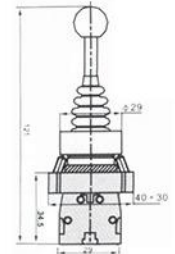
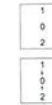

IS-BMR212
IS-BMR222

4 Position Stay Put
4 Position Spring Return



Contact

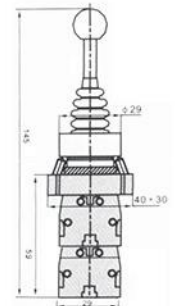

Control Box Series

- Our reliability is the result of our conscientiousness and willingness of our employees.
- We keep our promises and do so with competence and reliability.
- We guarantee good value for money
- Expert advice and sales support is the basic principle that enables us to meet your requirements
- We guarantee that we will keep to the agreed dates and appointments and this does not just apply to the delivery service for our products
- Reliability is one of the basic principles for ensuring our availability for you.

IS-JBOX1

Colors : 



IP
IP40
φ22 φ25

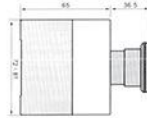

IS-JBOX2

Colors : 



IP
IP40
φ22 φ25

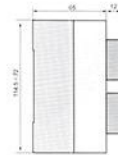

IS-JBOX3

Colors : 



IP
IP40
φ22 φ25

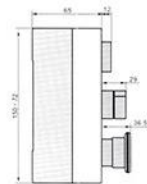

IS-JBOX4

Color : 



IP
IP40
φ22 φ25

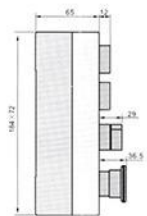

IS-EPC

Contact :
IS-ER60



Applied For
XB2-BC/BS
XB4-BC/BS

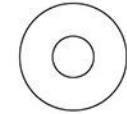

IS-EH2201

Contact :
IS-ER90



Applied For
XB2-BC/BG
XB4-BC/BG

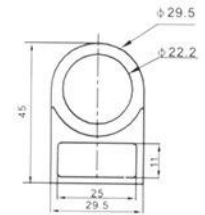

IS-EH2208 Meter

Contact :
IS-ER90



Applied For
XB2-BC/BG
XB4-BC/BG

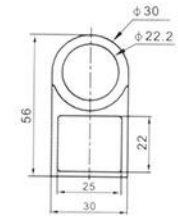

IS-AD22B-E06

Color : 



LAMP HOLDER
Porcelain E27





Control Switch Series

Everyday's Solution

Buttons marks

The EPB series are just among the wonderful control switches which are IP%100 ,67~54 Waterproof, Dust proof & shock proof. The spring-return, one flush Black &one flush white push buttons provide a patent design, optimum for highly professional operators. The NO and 2NO+NC type are one of the options for various usages



(A button) on, off(B button of spare button)OX

**IS-EPB2
IS-EPB22**

Symbol :



Contact : N/C+1N/O
NC+2/N/O

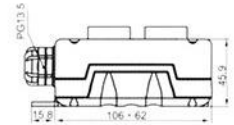

**IS-EPB3
IS-EPB32**

Symbol :



Contact : N/C+2N/O
NC+2/N/O+2N/O

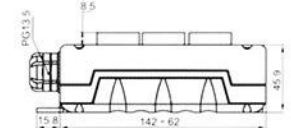

**IS-EPB4
IS-EPB42**

Symbol :



Contact : N/C+3N/O
NC+3/N/O+3N/O

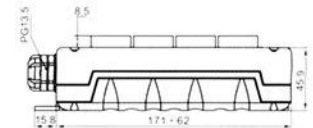

**IS-EPB5
IS-EPB52**

Symbol :



Contact : N/C+4N/O
NC+4/N/O+4N/O

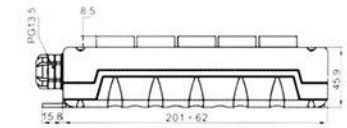

**IS-EPB6
IS-EPB62**

Symbol :



Contact : N/C+5N/O
NC+5/N/O+5N/O

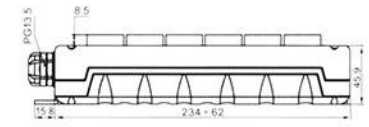

IS Series

- Compact new design approximately 3/1 the size of OMRON vertical Limit Switches.
- Structure enables the terminal section to be fully opened for easy wiring.
- Degree of protection: IP65

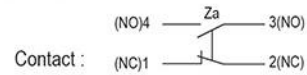

Ratings

Rated voltage	Noninductive Load (A)				Inductive Load (A)			
	Resistance Load		Lamp Load		Inductive Load		Motor Load	
	NC	NO	NC	NO	NC	NO	NC	NO
125VAC	5	5	1.5	0.7	3	3	2	1
250VAC	5	5	1	0.5	3	3	1.5	0.8
8VDC	5	5	3	3	5	4	3	3
14VDC	5	5	3	3	4	4	3	3
30VDC	5	5	3	3	4	4	3	3
125VDC	0.4	0.4						
250VDC	0.2	0.2						
Inrush Current	N.C.:24A N.O.:12A N.C. below 24A, N.O: below 12A							

Note:

1. Inductive load has a power factor of 0.4 min.AC and a time constant of 7 msec.max.(DC).
2. Lamp load has an inrush current of 10 times the steady-state current,while motor load has an inrush current of 6 times the steady-state current.
3. Product with spring, its usable range of operating part is within one third of the whole spring length from the front end of spring.

Characteristics

Operation speed	0.5mm-50cm/sec
Operating frequency	Mechanical: 120 operations/minute Electrical: 30 operations/minute
Contact resistance	25m Ω max. (initial value)
Insulation resistance	100m Ω min. (below 500VDC)
Dielectric strength	1000VAC, 50/60 Hz for 1 minute between terminals of the same polarity
	1500VAC, 50/60 Hz for 1 minute between current-carrying and non-current-carrying metal ports
Vibration	1500VAC, 50/60 Hz for 1 minute between each terminal and ground
	10-55Hz,1.5mm double amplitude
Shock	Mechanical durable: 1,000m/Sec ² (about 100G'S) Malfunction: 300m/sec ² (about 30G'S)
Ambient temperature	-5~+65°C (With no icing)
Humidity	<95% RH
Weight	About 130 to 190g
Degree of protection	IP65

IS-8104



Operating Characteristics

OF (Max)	5.88N
RF (Min)	0.49N
PT(Max)	20°
OT (Min)	75°
MD (Max)	10°
TT (Min)	95°
OP	-

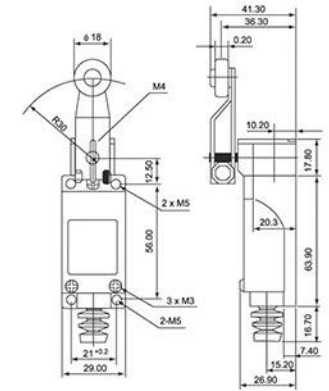

IS-8107



Operating Characteristics

OF (Max)	5.88N
RF (Min)	0.69N
PT(Max)	20°
OT (Min)	75°
MD (Max)	10°
TT (Min)	95°
OP	-

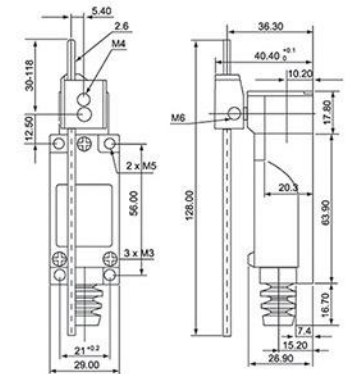

IS-8108



Operating Characteristics

OF (Max)	7.84N
RF (Min)	0.49N
PT(Max)	20°
OT (Min)	75°
MD (Max)	10°
TT (Min)	95°
OP	-

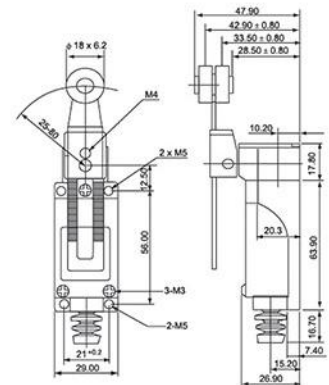

IS-8111



Operating Characteristics

OF (Max)	9.8N
RF (Min)	2.94N
PT(Max)	1.5mm
OT (Min)	4mm
MD (Max)	1.2mm
TT (Min)	5.5mm
OP	26±0.8mm

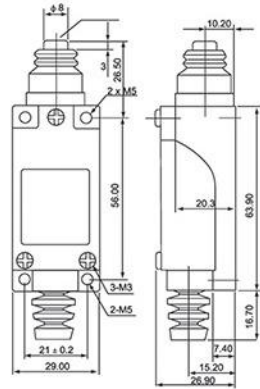

IS-8112



Operating Characteristics

OF (Max)	9.8N
RF (Min)	2.94N
PT(Max)	1.5mm
OT (Min)	4mm
MD (Max)	1.2mm
TT (Min)	5.5mm
OP	-

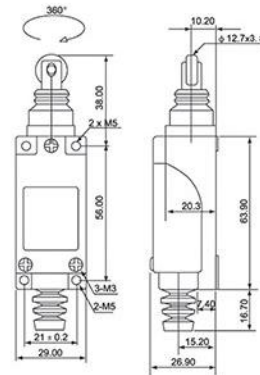

IS-8122



Operating Characteristics

OF (Max)	9.8N
RF (Min)	2.94N
PT(Max)	1.5mm
OT (Min)	4mm
MD (Max)	1.2mm
TT (Min)	5.5mm
OP	-

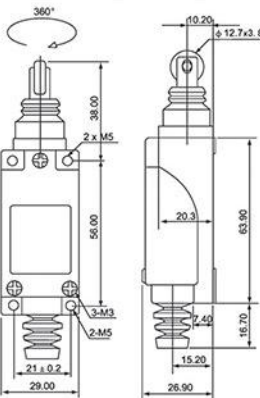

IS-8166

Operating Characteristics

OF (Max)	0.88N
PT(Max)	30mm



IS-8167

Operating Characteristics

OF (Max)	0.88N
PT(Max)	30mm



IS-8168

Operating Characteristics

OF (Max)	0.88N
PT(Max)	30mm



IS-8169

Operating Characteristics

OF (Max)	0.88N
PT(Max)	30mm

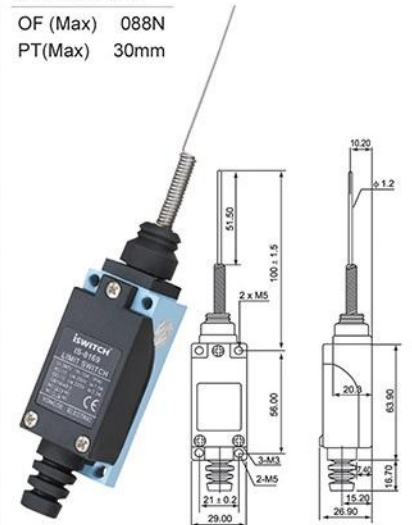

ISC Series

- Strong metal outer shell, swing arm max. ±95°
- Stainless steel idler wheel, punch and spring
- Selective M18x1.5 cable gland

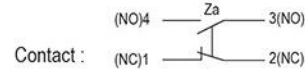

Characteristics

Double Breck Mechanism	INO+INC Force Break snap action
Rated Voltage / Current	10(4)A, 125, 250VAC / 6(2)A, 380VAC For inductance Load, Cos φ = 0.4
Contact Resistance	25mΩ max.(initial value)
Insulation Resistance	100m min. (at 500 VDC)
Dielectric Strength	1000VAC, 50/60 Hz for 1 minute between terminals of the same polarity
	1500VAC, 50/60 Hz for 1minute between current-carrying and non-current-carrying metal parts
	1500VAC, 50/60 Hz for 1minute between each terminal and ground
Opercting Speed	5mm/s to 0.5m/s
Degree of Protection	IP40
Ambient Temperature Rised	Max 30°C over ambient temperature at rated voltage/current
Conformed Standards	Cenelec EN 50041, EN 50047, IEC 337-1, VDE 0660
Opercting Temperature	-5°C -+65°C (with no icing)
Storage Temperature	-5°C -+65°C (with no icing)
Ambient Opercting Humdity	95% RH Max.
Shock Resistance	Mechanical durable: 1000m/s ² min. Malfunction: 300m/s ² min.
Vibration Frequency	Malfunction: 10 to 55Hz, 1.5mm double amplitude
Terminal Screw Torsional Force	6-8 kgf-cm
Other Screw Torsional Force	Cover 12-14 kgf-cm/Head 8-9 kgf-cm/Mounting 50-60 kgf/cm
Bare Wire Diameter	φ 2 Max
Cable Diameter	φ 12 Max (IP 65 if use cable φ 8-9)

ISC-001



Operating Characteristics

OF (Max)	7.84N
RF (Min)	3.92N
PT(Max)	1.8mm
TP ± 10%	2.0mm
MD (Max)	1.2mm
OT (Min)	4.0mm
TT (Min)	5.8mm

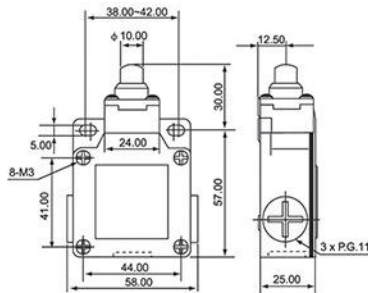

ISC-003



Operating Characteristics

OF (Max)	7.84N
RF (Min)	3.92N
PT(Max)	1.8mm
TP ± 10%	2.0mm
MD (Max)	1.2mm
OT (Min)	4.0mm
TT (Min)	5.8mm

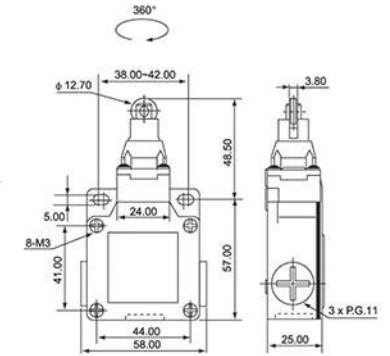

ISC-012



Operating Characteristics

OF (Max)	7.84N
RF (Min)	3.92N
PT(Max)	1.8mm
TP ± 10%	2.0mm
MD (Max)	1.2mm
OT (Min)	4.0mm
TT (Min)	5.8mm

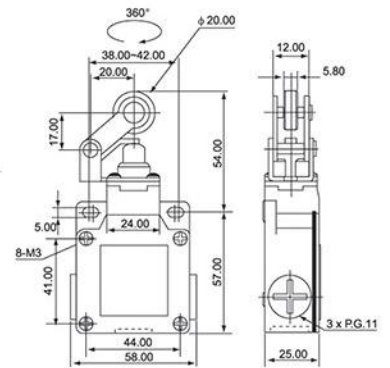

ISC-021



Operating Characteristics

OF (Max)	3.92N	MD (Max)	10°
RF (Min)	0.98N	OT (Min)	75°
PT(Max)	20°	TT (Min)	95°
TP ± 10%	22.5°	RI	22.5°

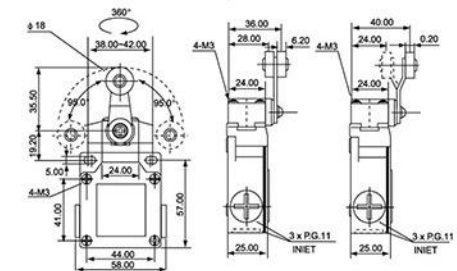

ISC-031



Operating Characteristics

OF (Max)	3.92N
RF (Min)	0.98N
PT(Max)	20°
TP ± 10%	22.5°
MD (Max)	10°
OT (Min)	75°
TT (Min)	95°
RI	22.5°

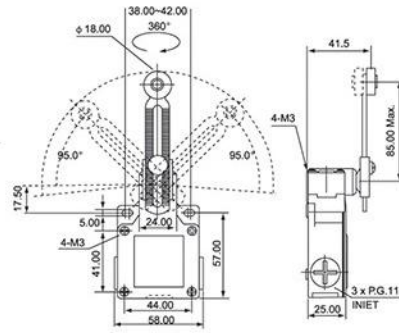

ISC-061



Operating Characteristics

OF (Max)	1.47N
RF (Min)	0.49N
PT(Max)	30mm
TP ± 10%	22.5°
MD (Max)	14°
OT (Min)	20mm
TT (Min)	50mm

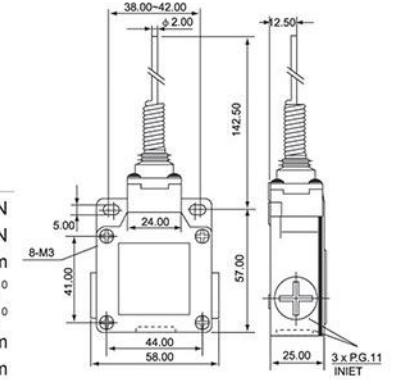

ISC-041



Operating Characteristics

OF (Max)	3.92N
RF (Min)	0.98N
PT(Max)	20°
TP ± 10%	22.5°
MD (Max)	10°
OT (Min)	75°
TT (Min)	95°
RI	22.5°

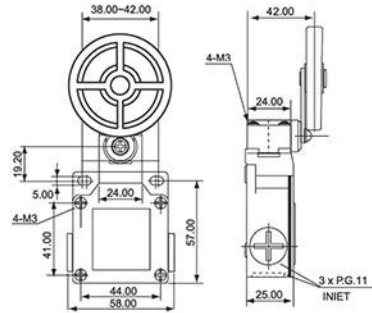

ISC-071



Operating Characteristics

OF (Max)	1.47N
RF (Min)	0.49N
PT(Max)	30mm
TP ± 10%	22.5°
MD (Max)	14°
OT (Min)	20mm
TT (Min)	50mm

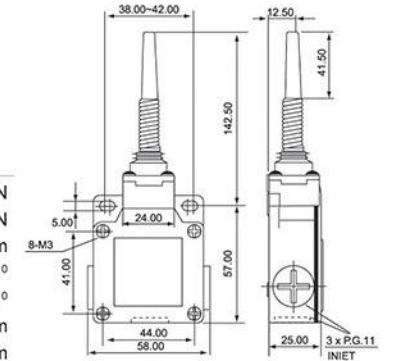

ISC-051



Operating Characteristics

OF (Max)	3.92N
RF (Min)	0.98N
PT(Max)	20°
TP ± 10%	22.5°
MD (Max)	10°
OT (Min)	75°
TT (Min)	95°
RI	22.5°

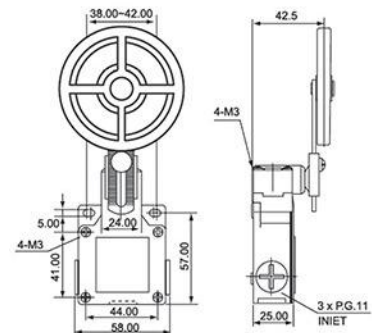

ISC-081



Operating Characteristics

OF (Max)	1.47N
RF (Min)	0.49N
PT(Max)	30mm
TP ± 10%	22.5°
MD (Max)	14°
OT (Min)	20mm
TT (Min)	50mm

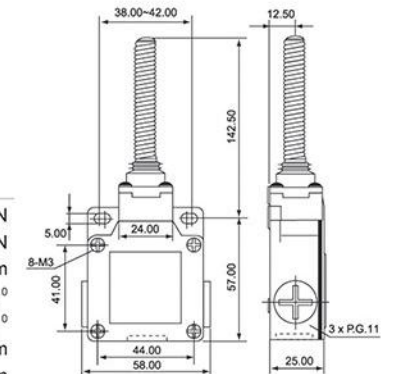



Limit Switch

Series
Everyday's **Solution**

ISWLCA2-2

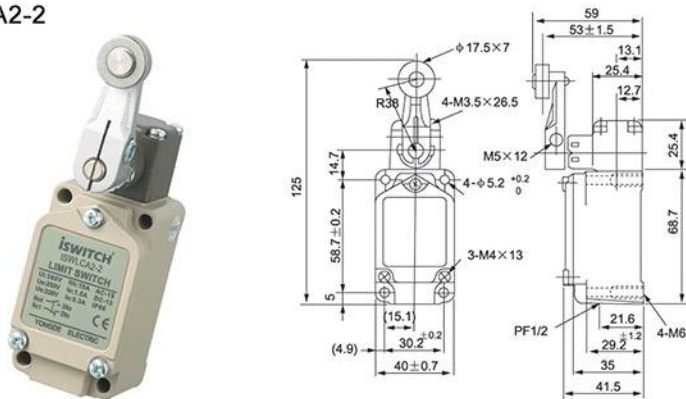

ISWLCA12-2-Q

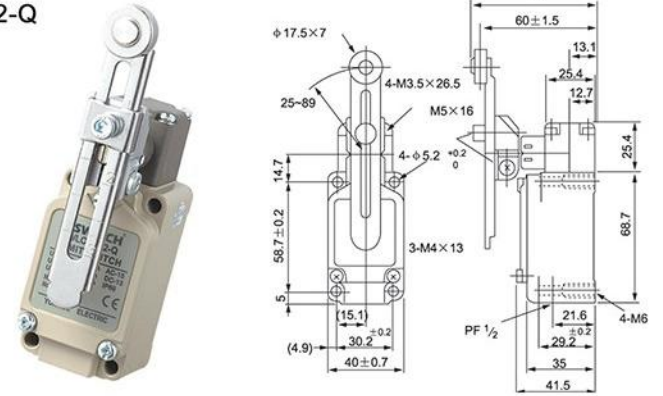

ISWLCA12-2-QD

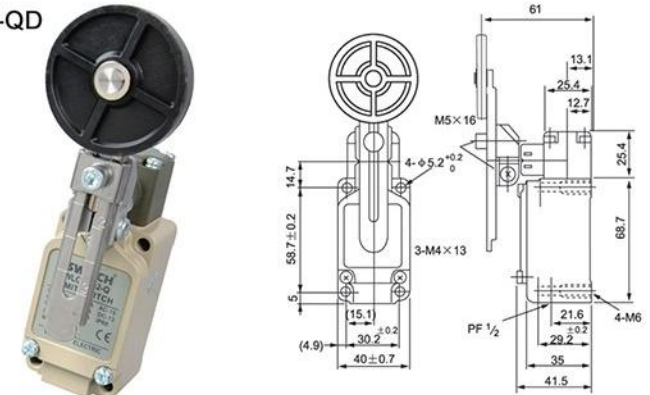

ISWLCL

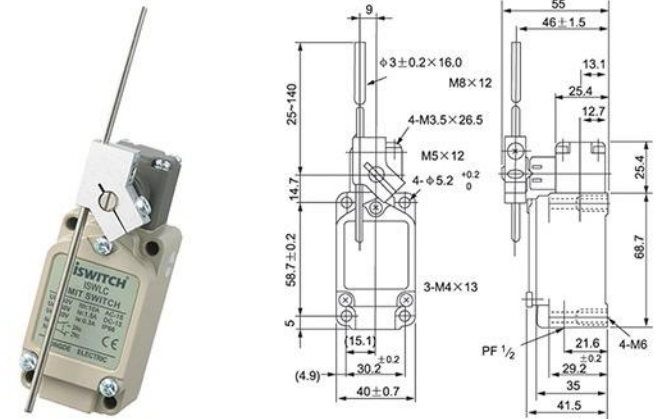

ISWLD

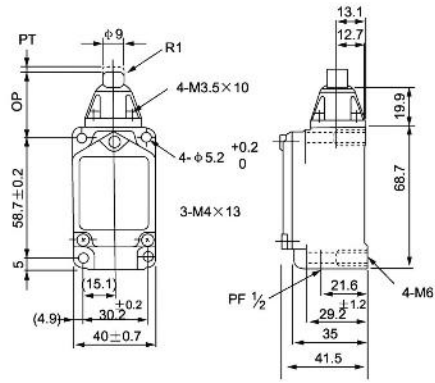

ISWLD3

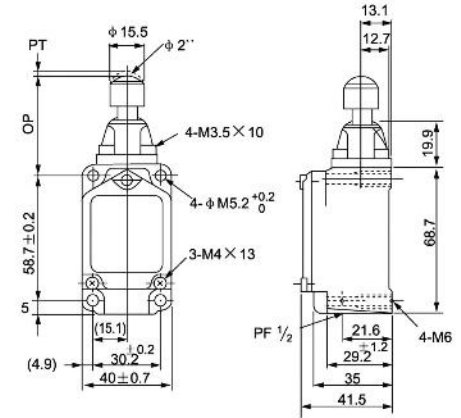

ISWLD1

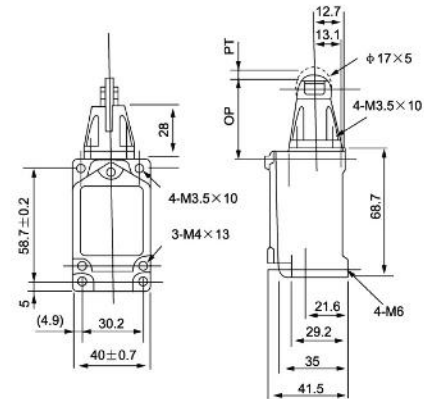

ISWLNJ

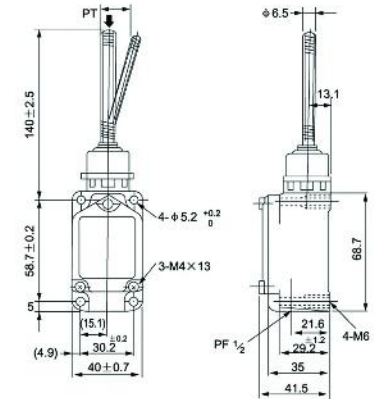

ISWLD2

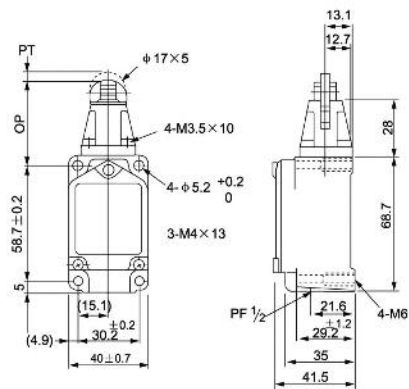

ISWLNJ-30

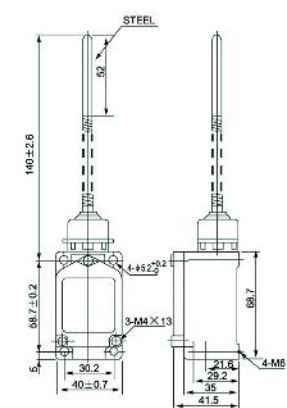

ISWLNJ-2

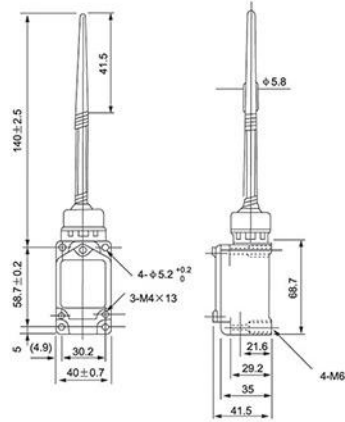

ISWLNJ-S2

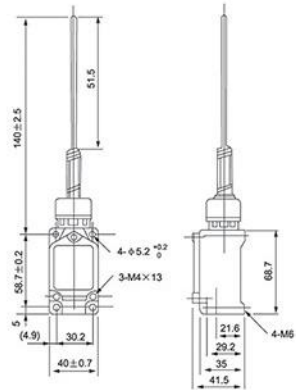

ISWLCA32-41

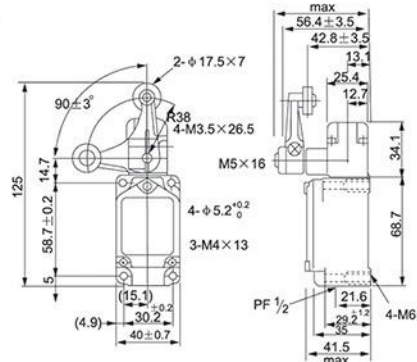

ISWLCA32-42

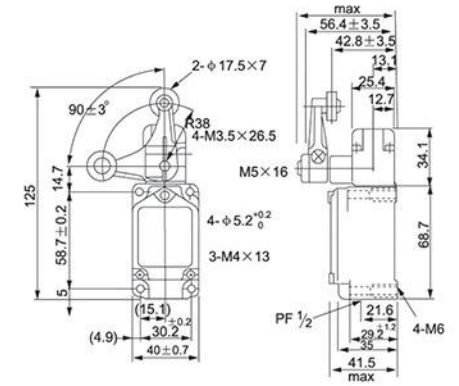

ISWLCA32-43

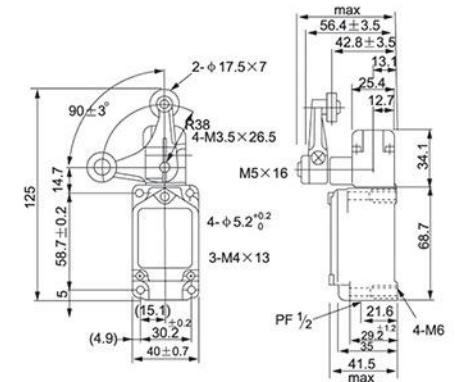

ISWLCA32-44

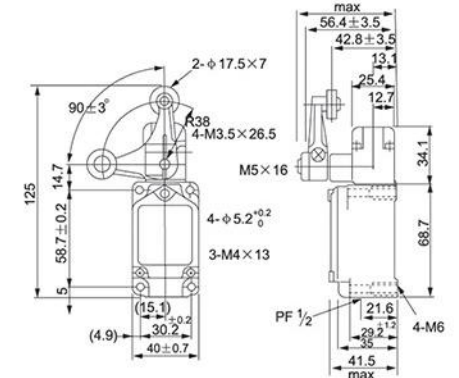

ISMM Series

- A large switching capacity of 15 A with high repeat accuracy.
- A wide range of variations in contact form for your selection: basic, splitcontact, maintained-contact, and adjustable contact gap types.
- A series of standard models for micro loads is available
- A series of molded terminal-type models incorporating safety terminal protective cover is available.

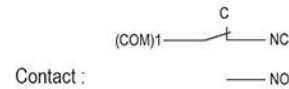

Ratings

Rated voltage	Noninductive Load (A)				Inductive Load (A)				Inrush Current	
	Resistance Load		Lamp Load		Inductive Load		Motor Load			
	NC	NO	NC	NO	NC	NO	NC	NO	NC	NO
125VAC	15	15	3	1.5	15	15	5	2.5	30	15
250VAC	15	15	2.5	1.25	15	15	3	1.5		
500VAC	3	3	1.5	0.75	2.5	2.5	1.5	0.75		
8VDC	15	15	3	1.5	15	15	5	2.5	MAX	MAX
14VDC	15	15	3	1.5	10	10	5	2.5		
30VDC	6(2)	6(2)	3	1.5	5	5	5	2.5		
125VDC	0.4	0.4	0.4	0.4	0.05	0.05	0.05	0.05		
250VDC	0.2	0.2	0.4	0.2	0.03	0.03	0.03	0.03		

Characteristics

Operation speed	0.01mm-1m/sec
Operating frequency	Mechanical: 240 operations/min. Electrical: 20 operations/min.
Contact resistance	15mΩ max. (initial value)
Insulation resistance	100mΩ min. (at 500VDC)
Dielectric strength	1000VAC, 50/60 Hz for 1 minute between terminals of the same polarity
	1500VAC, 50/60 Hz for 1 minute between current-carrying and non-current-carrying metal parts
Vibration	1500VAC, 50/60 Hz for 1 minute between each terminal and ground
	10-55Hz, 1.5mm double amplitude
Shock	Mechanical durable: 1,000m/Sec ² (about 100G'S)
	Malfunction: 300m/sec (about 30G'S)
Ambient temperature	General purpose type: -25°C to +80°C, Sealed type: -15°C to +80°C
Humidity	General purpose type: 85% RH max., Sealed type: 95% RH max.
Weight	About 22 to 58g

ISM-1701

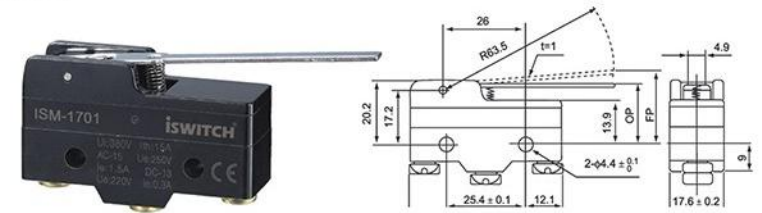

ISM-1702

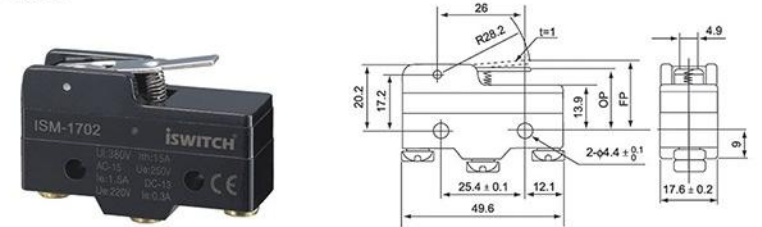

ISM-1703



ISM-1704

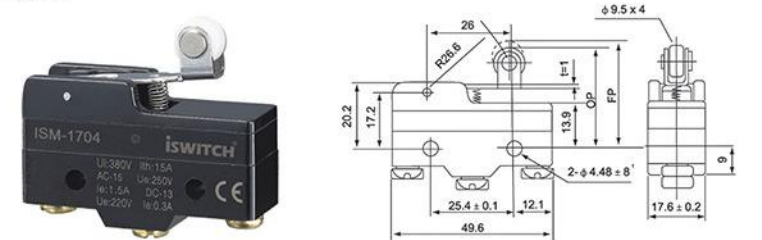

ISM-1705

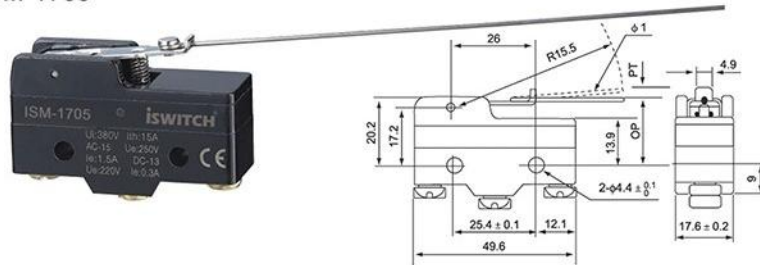

ISM-1724

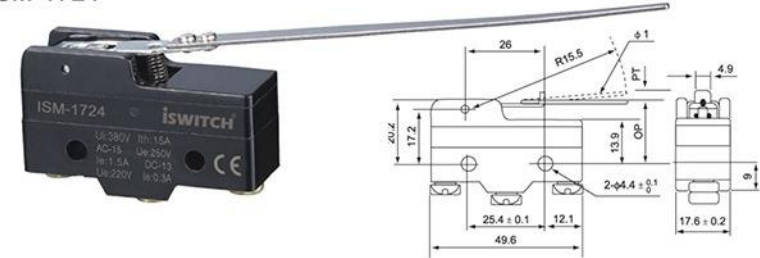

ISM-1306

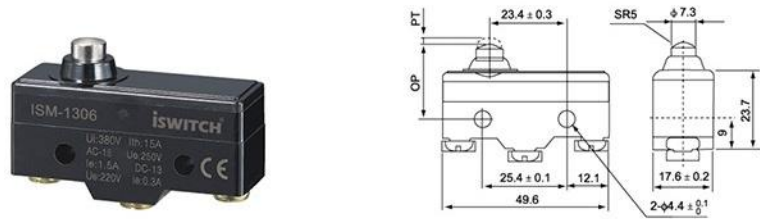

ISM-1300

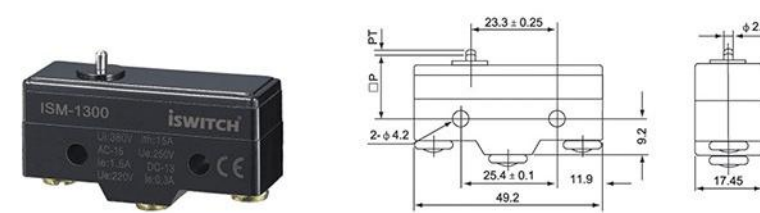

ISM-1307

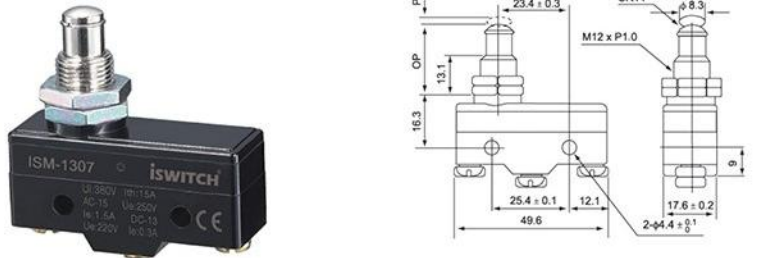

ISM-1301

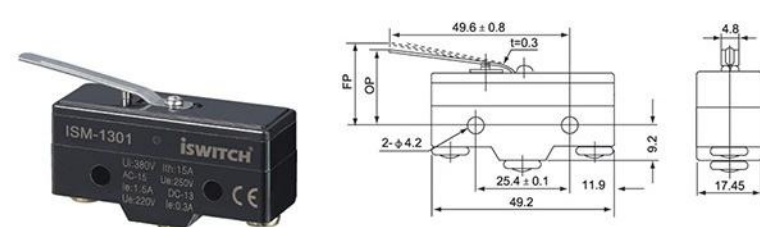

ISM-1743

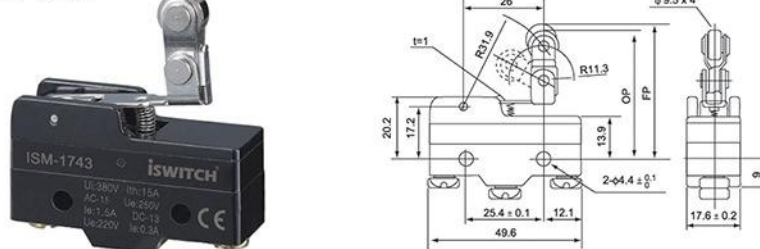

ISM-1303

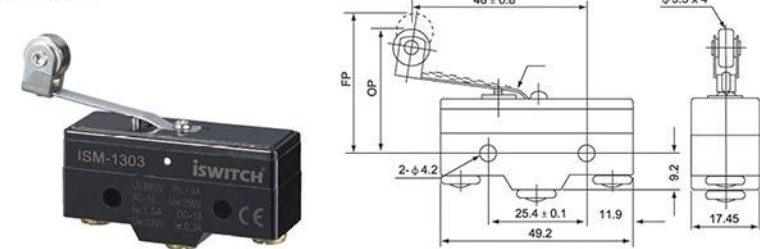

ISM-1305

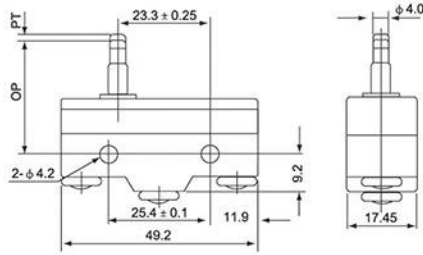

- TM1-11 uses the environment, the shape, the installation procedure, and (TM micro switch) the same
- Degree of protection reaches IP67 (except for terminal part)
- High switch on and off capacity(15A)
- High accuracy
- Wide range of operation speed

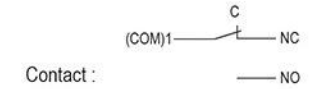

ISM-1308

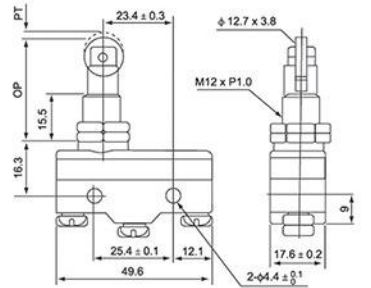

ISM-1306-1

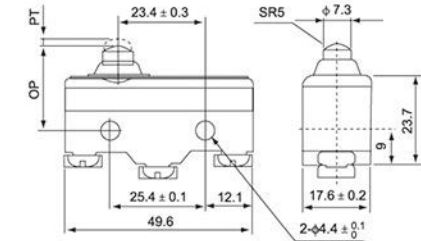

ISM-1309

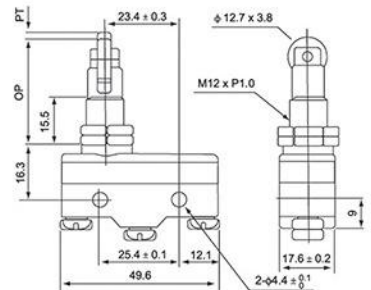

ISM-1306-2

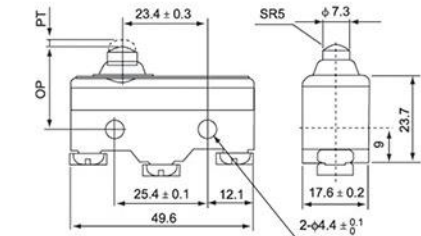

IAP-S



IAP-Y



ISM-1701-1

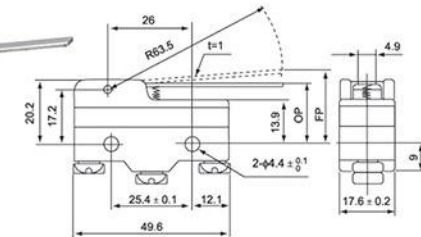

ISM-1703-1

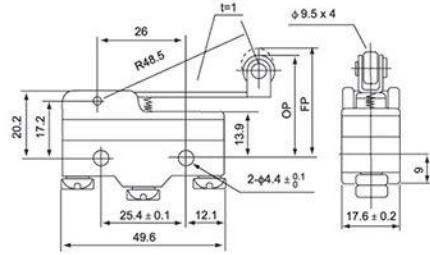

ISM-1704-1

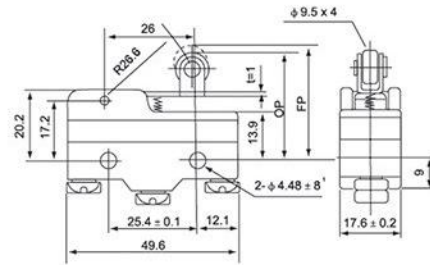

ISM-1705-1

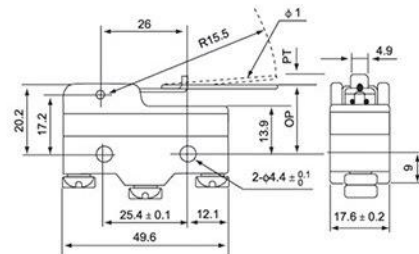

ISM-15-1C25

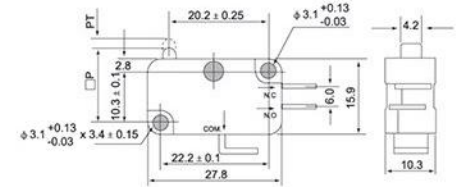

ISM-15-1C5

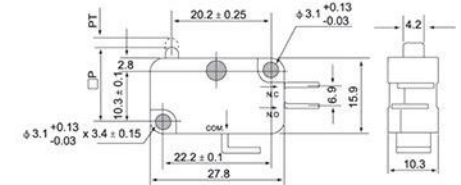

ISM-151-1C25

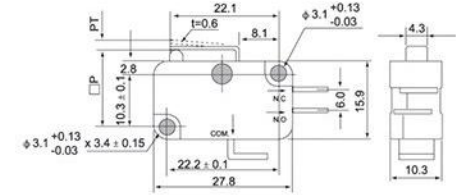

ISM-151-1C5

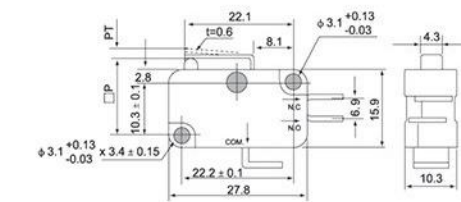

ISM-152-IC25

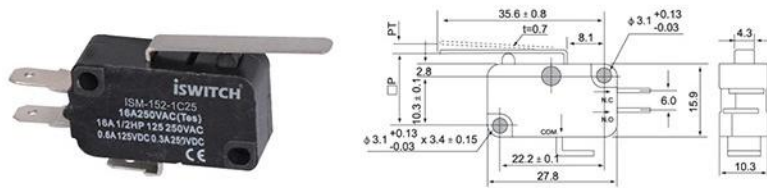

ISM-154-IC25

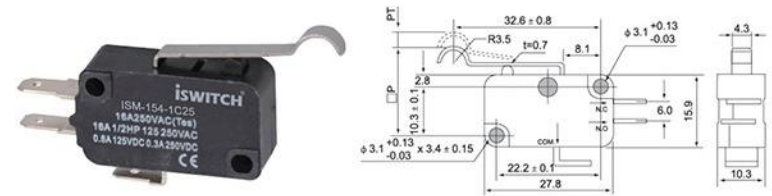

ISM-152-IC5

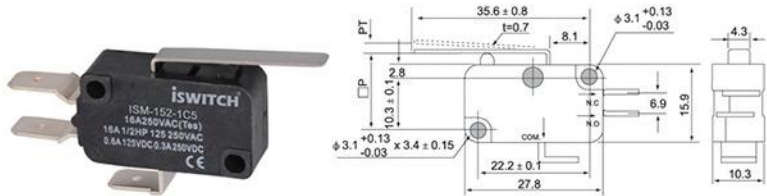

ISM-154-IC5

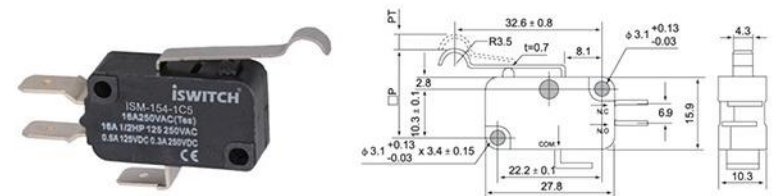

ISM-153-IC25

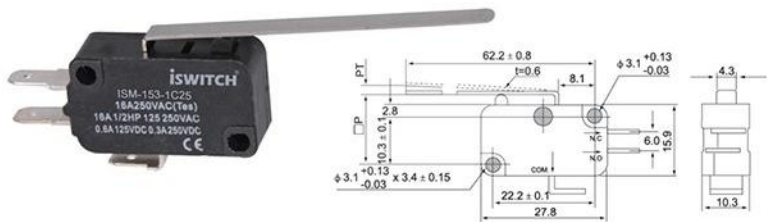

ISM-155-IC25

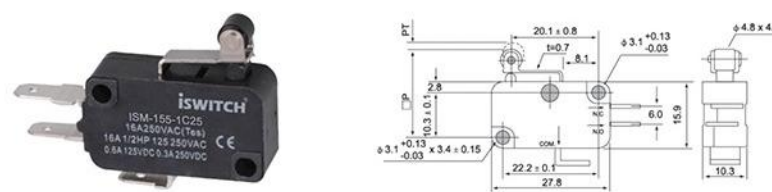

ISM-153-IC5

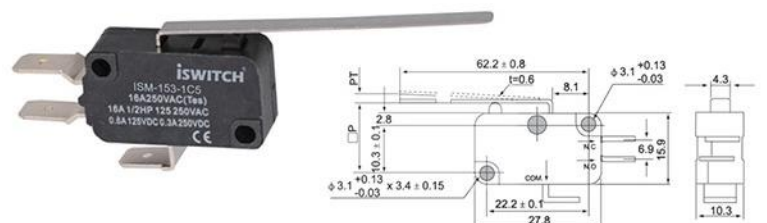

ISM-155-IC5

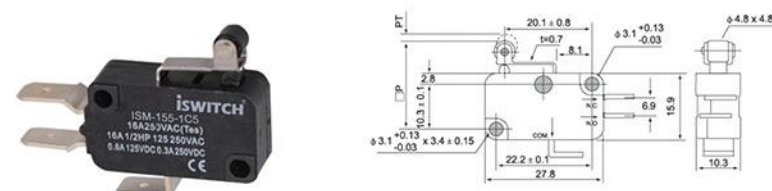

ISM-156-IC25

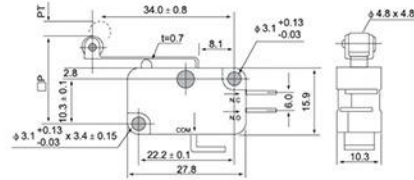

ISM-15-1A25

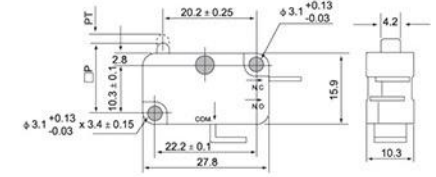

ISM-156-IC5

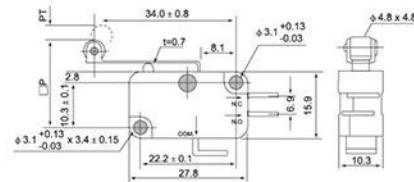

ISM-15-1B25

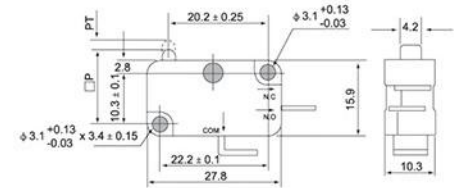

ISM-VAQ-D

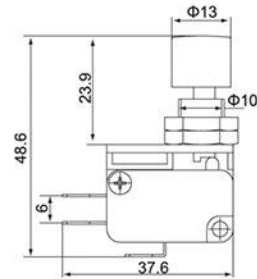

ISM-VAQ-C

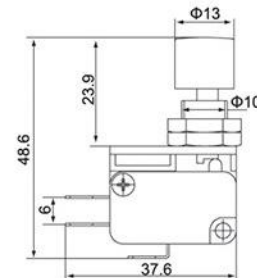

Micro Switch Series
Everyday's **Solution**

آر-سوئیچ الکتریک®

راهکاری برای هر روز

Sales Distributor: